

# Comment and Search

Mobsted has tools to leave comments on everything you do within your application, so that you can easier remember how things are done at a latter time, or someone else can understand and work with your application.

**WE HIGHLY RECOMMEND YOU ALWAYS USE THIS FUNCTIONS TO CUT DOWN LEARNING AND LAUNCH TIME.**

- 1. Commenting and Notes
  - Notes for the Screen
- 2. Searching and Mapping
  - Selecting what to Search for
  - Making a Search
  - Using Search Results
    - Viewing the panel
    - Jumping to the found instance
    - Special attention

## 1. Commenting and Notes

When in Constructor, of say a Demo App. You see a tab on each of its elements.

### Notes for the Screen

Here you can see Notes for the Entire screen of the app.

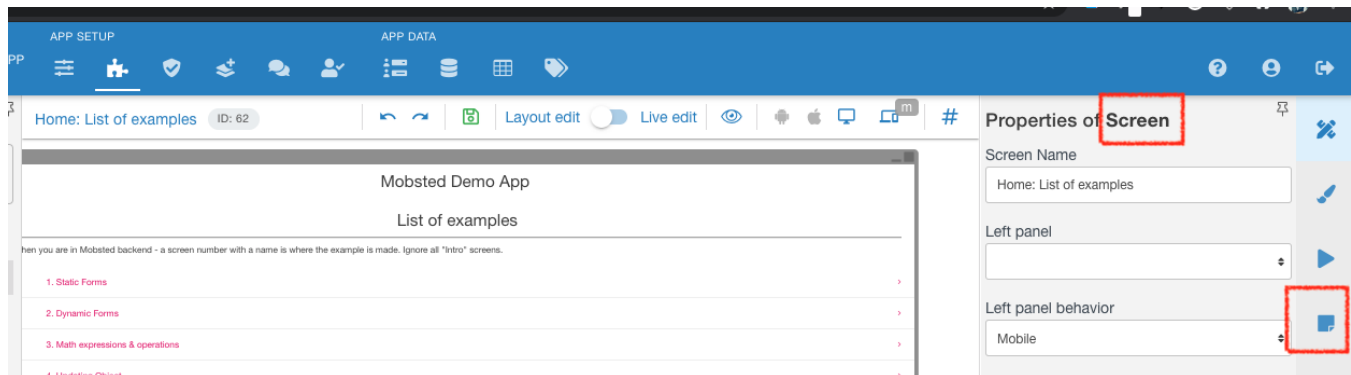

Click on the Notes tab on you right marked **red** , to get notes for the screen marked **red**

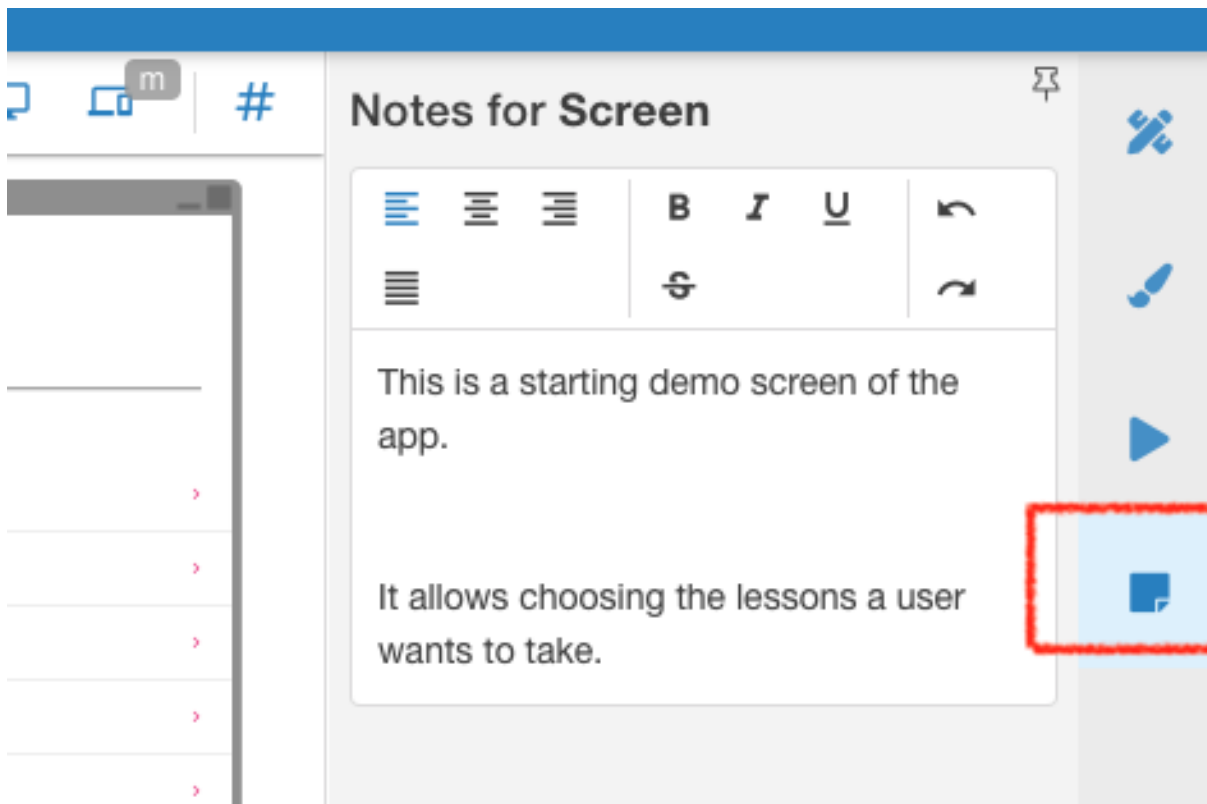

#### Notes for the Element/Component

If any of your elements is selected pressing Notes will go to notes for that particular element, marked red .

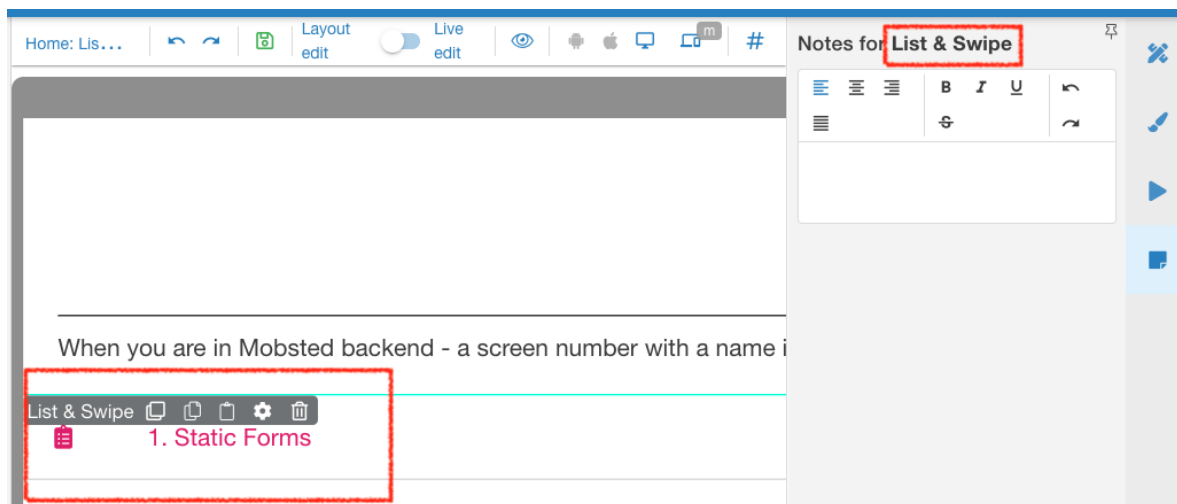

As you can see, a List and Swipe type element is selected.

## 2. Searching and Mapping

It often happens that you need to remember WHERE you used one or the other variable, hashtag or a backendname, or anything else. You can

## Selecting what to Search for

Decide what you need to find in your app, for example, let it be a variable you want to find how it is set and where else used:

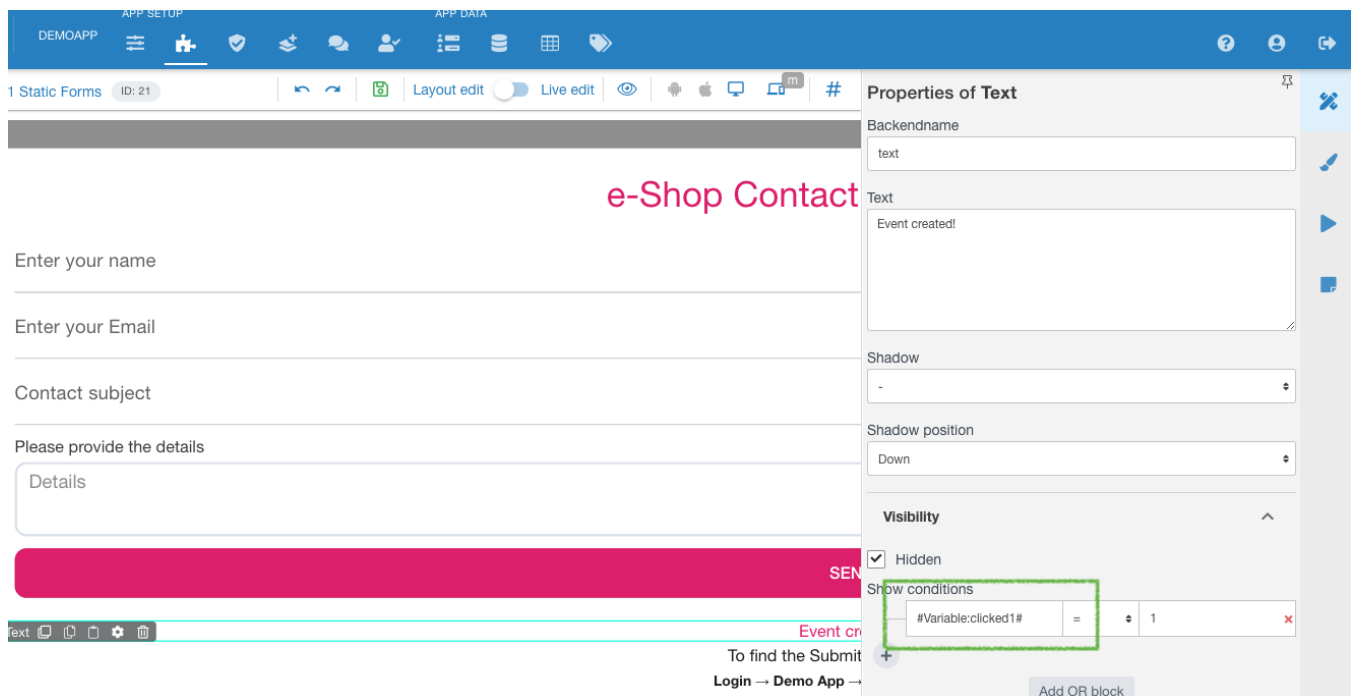

Select a part you want to search with your mouse:



## Making a Search

Click The Search tab button on your left panel, marked **RED** .

Of course, you can type into search anything you need **MANUALLY**, too.

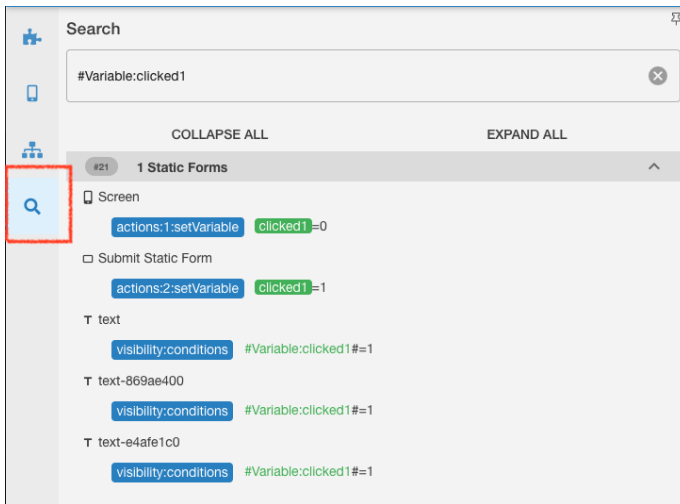

You will see results for what you are looking for.

## Using Search Results

### Viewing the panel

Search results depend on what you are looking for and may contain or not contain certain extra data in the panel, but the overall view is always the same:

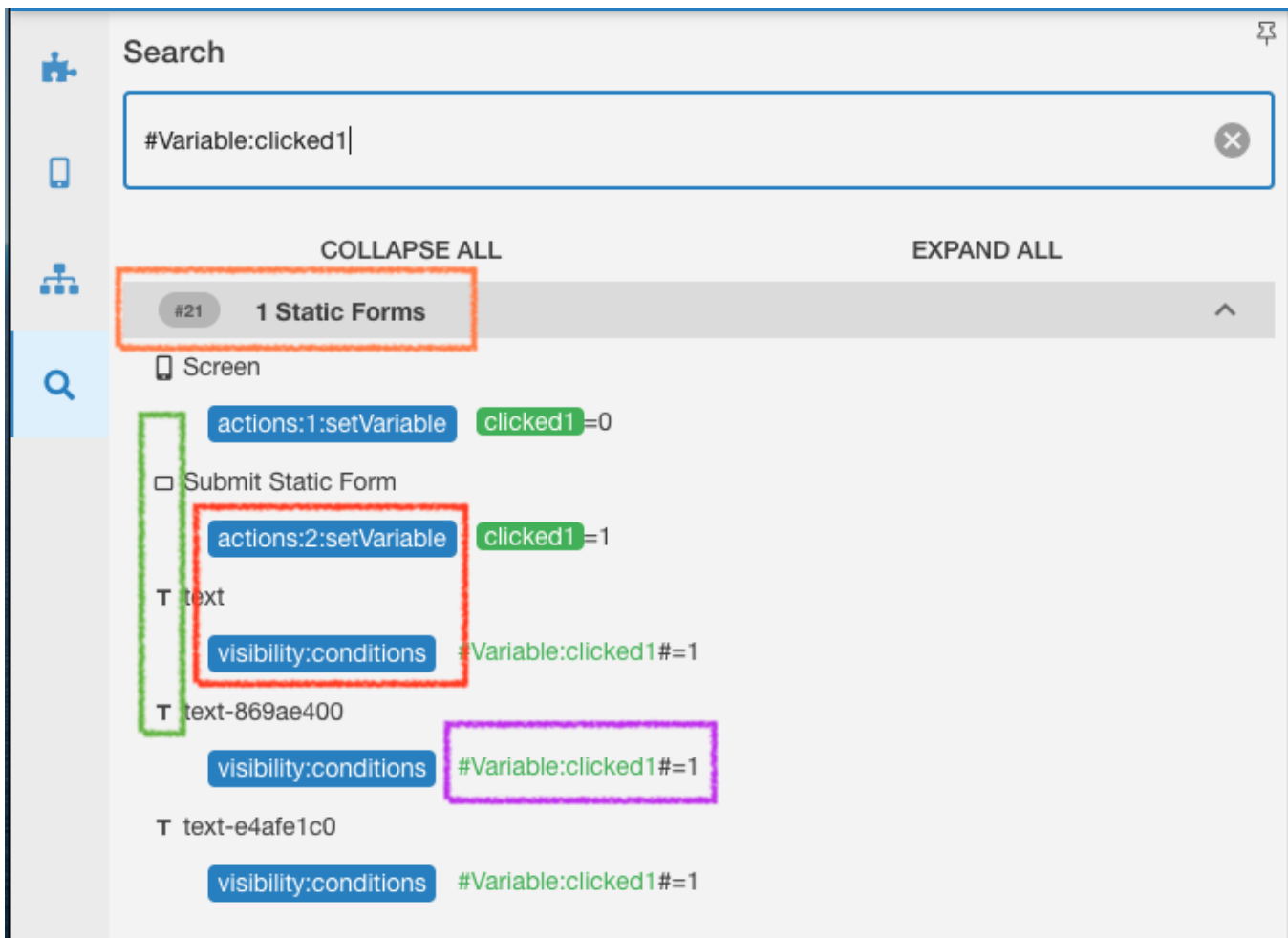

Where,

**Orange** is a screen where its located

**Green** is a Type of an element, where it's located, - it can be a Screen itself, of a button, or a text field or anything else.

**Red** is a place in Element's right panel, where exactly is it's found, so either of functions on either of Properties, View or Actions tabs

**Purple** is the full text where it's found, with the matching result selected in **green**.

So in this search you can instantly see, that this variable called "clicked1" is set FIRST on a screen itself to = 0. Then also set in Action in a static form to switch to = 1. Then the "=1" is used in visibility conditions on 3 different Text elements.

### Jumping to the found instance

Just point and click (marked ) to any found record to jump to it in the constructor. You will have the right screen, with the right element and the right panel on you, yes, RIGHT.

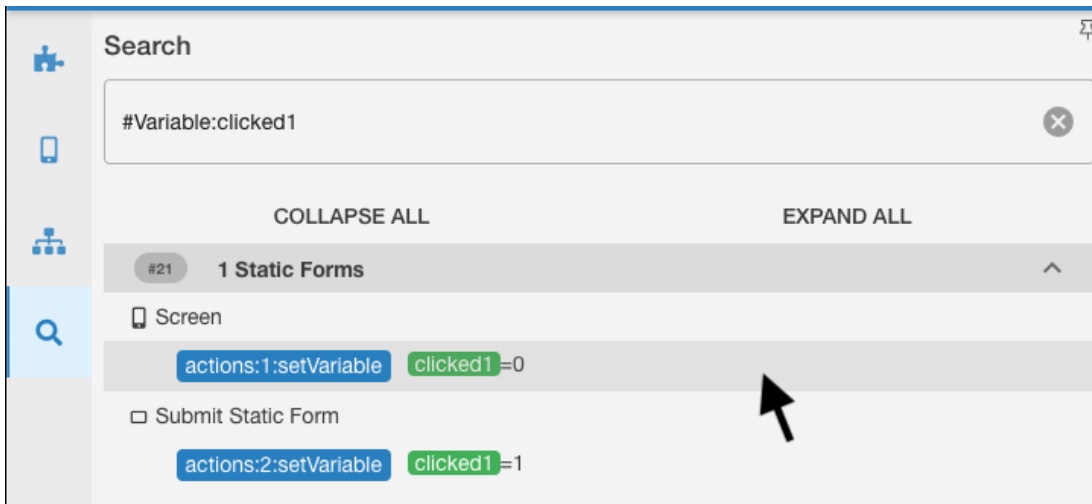

### Special attention

Some search can return "**Tenant:local**" section in search results. For example:



Those are other found spots, but **you CAN NOT JUMP to those places by clicking each result**. We recommend to open a second tab in your browser for it and look for those places manually.